

# Charles Adapter Kit for FSDC-H

## 97-FSDCHADPGKIT

### General Description and Installation

1. GENERAL INTRODUCTION ..... 1  
 1.1. Document Purpose ..... 1  
 1.2. Product Purpose ..... 1  
 2. INSTALLATION ..... 1  
 2.1. Obtaining Tools and Equipment ..... 1  
 2.2. Install the Adapter ..... 2  
 3. TECHNICAL ASSISTANCE AND CUSTOMER SERVICE ..... 2

## 1. GENERAL INTRODUCTION

### 1.1. Document Purpose

This document provides general information for the 97-FSDCHADPGKIT adapter kit for the FSDC-H fiber closure. Figure 1 shows the kit components.

-NOTE-

*Hereafter, the Charles 97-FSDCHADPGKIT adapter kit will be referred to as the "kit."*

### 1.2. Product Purpose

The kit is used for performing a field upgrade to add ports to an FSDC-H splice closure. The kit contains two OptiTap® compatible H-adapters and two-color coded (blue and orange) 900µm SMF pigtailed with SC/APC connectors. Remove two drop port plugs from the FSDC-H and replace them with the fiber adapters included with the kit.

## 2. INSTALLATION

### 2.1. Obtaining Tools and Equipment

Obtain the following recommended or needed items for installing the kit.

- Protective and/or insulated work gloves
- Safety glasses
- Slotted screwdriver

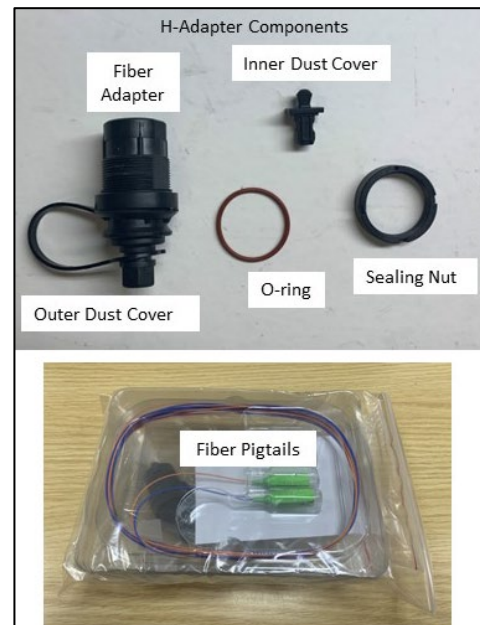

**Figure 1 Kit Components**

## 2.2. Install the Adapter

1. Use a slotted screwdriver to pry open the four latches on the FSDC-H (Figure 2).
2. Locate the sealing nut on the inside of the drop port that is being replaced. This sealing nut has several notches all around. Use a slotted screwdriver to loosen this nut (Figure 3). Remove and set aside.
3. Remove the drop port plug and set aside (Figure 4).
4. Remove the sealing nut from the adapter. Ensure that the red o-ring is placed on the threaded section of the fiber adapter, so that it will be on the external side of the drop port (Figure 5). Ensure that the dust covers are securely placed and tightened.
5. Insert the adapter into the open drop port.
6. Use the sealing nut to secure the fiber adapter in the drop port, using a slotted screwdriver to tighten.
7. The pigtails are color coded blue and orange. Be aware and document which fiber the pigtail is spliced to in the FSDC-H as it may be of a different color.
8. Repeat this procedure for any additional ports to be upgraded.
9. Close the FSDC-H.



**Figure 2**  
Open FSDC-H

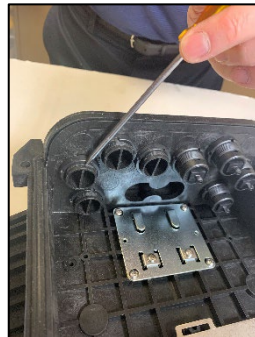

**Figure 3**  
Loosen Sealing Nut



**Figure 4**  
Remove Drop Port Plug

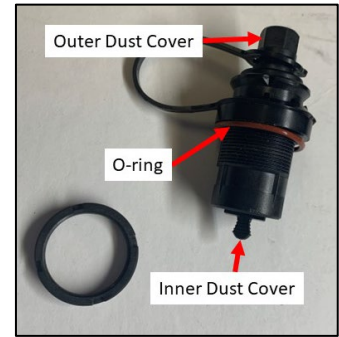

**Figure 5**  
Place O-Ring

## 3. TECHNICAL ASSISTANCE AND CUSTOMER SERVICE

For questions on product repair or if technical assistance is required, contact Charles Technical Support.

847-806-8500  
[techserv@charlesindustries.com](mailto:techserv@charlesindustries.com) (email)  
<http://www.charlesindustries.com/techserv.htm>

For questions on warranty or other customer service assistance, contact your Charles Customer Service Representative.

847-806-6300  
[mktserv@charlesindustries.com](mailto:mktserv@charlesindustries.com) (email)  
[http://www.charlesindustries.com/main/telecom\\_sales\\_support.htm](http://www.charlesindustries.com/main/telecom_sales_support.htm)