

Optical Hub Cabinets (OHC) provide fiber distribution to subscribers from a compact, environmentally protected outdoor terminal. OHC have been designed with flexibility in mind and support fusion, pre-terminated and field terminated feed and drop fibers. These PON terminals have space for multiple splitters for incremental growth. They may be pad mounted and are well suited for multi-dwelling unit (MDU) distribution in centralized or distributed Optical Network Terminals (ONT). The OHC 432 houses 48 feed/pass-thru adapters and 432 distribution adapters for fiber distribution to high density buildings with many potential subscribers.

OHC are constructed from powder-coated aluminum that is both durable and lightweight. The unit can be quickly installed by a single technician. Front and rear dual access doors are secured with low-profile, 216-tool quarter turn locks and padlock hasps for additional access control. A grounding bus bar with multiple grounding studs is provided.

MARKETS SERVED:

- ☒ Telecom / FTTX
- ☒ Utility
- ☐ Wireless
- ☒ Broadband Cable



OHC2-432 Enclosure
(shown with optional 6" plinth)

FEATURES

- Supports pre-terminated and field terminated feed and drop fibers
- Front and rear access doors are secured with low-profile, 216-tool quarter turn locks and padlock hasps for additional access control
- Durable and lightweight pad mount enclosure can be quickly installed
- Multiple cable entry locations are positioned at the bottom of the enclosure, allowing flexible placement of feed and distribution cables
- Fiber bend radius controls and routing guides ensure cable management and proper slack storage
- Charles Fiber Splitter Modules (CFSM) are available with optimized pigtail lengths
- Constructed from powder-coated aluminum
- Well suited for centralized split in a Passive Optical Network (PON)

OHC2-432 Optical Hub Cabinet

DIMENSIONAL VIEWS

All dimensions given in inches

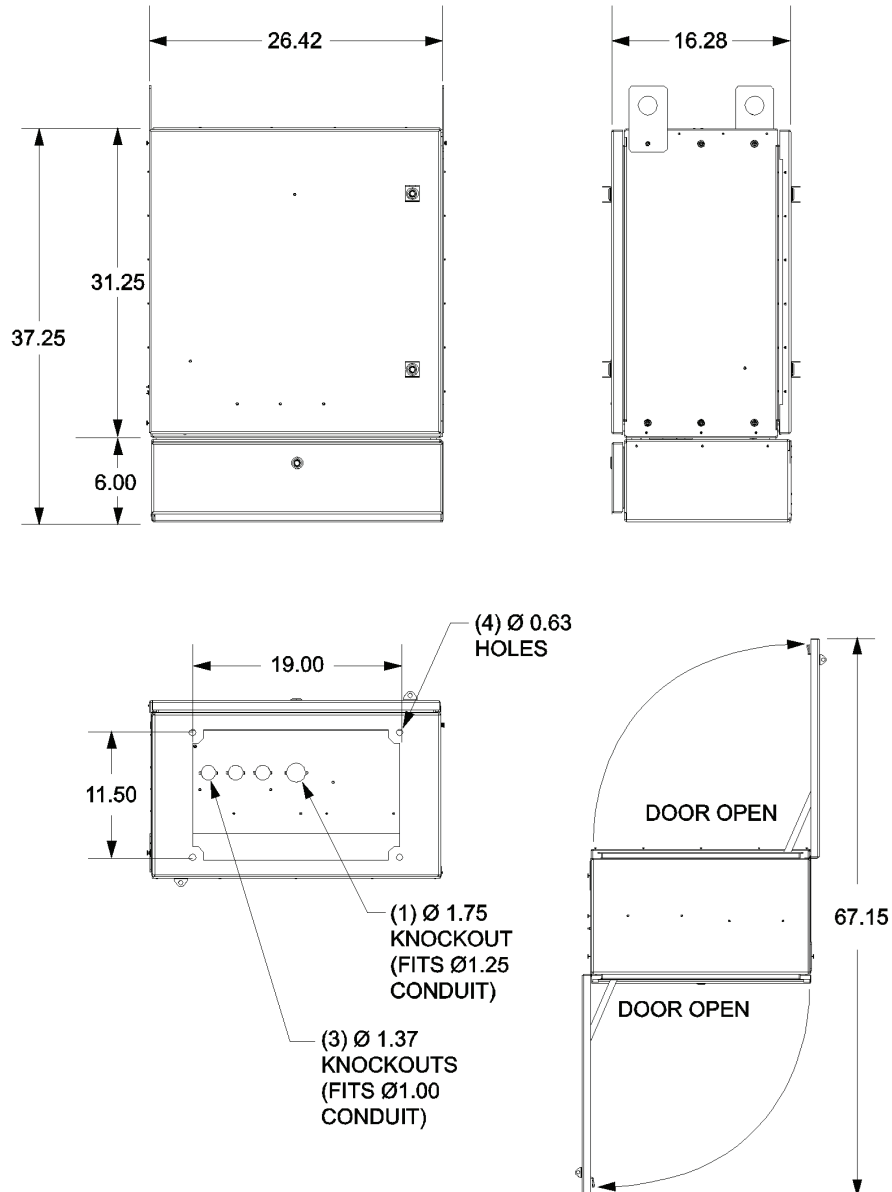

Overall Dimensions:	31.3"H x 26.4"W x 16.3"D (without plinth) 37.3"H x 26.4"W x 16.3"D (with 6" plinth)
Weight (empty):	81 lbs. (without plinth) 99 lbs. (with 6" plinth)
Splitter Capacity:	28
Scalable Bulkhead:	48 Feed / 432 Distribution Maximum
Adapter Type:	SC/APC
Finish:	Off-White Powder Coated

OHC2-432 Optical Hub Cabinet

OHC2-432 SPLITTER COMPARTMENT

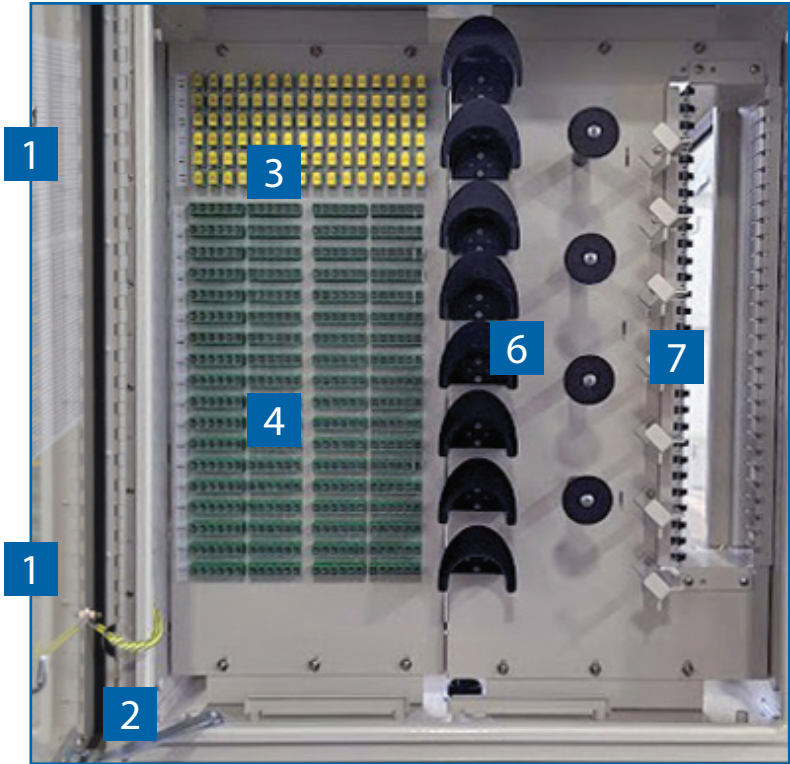

COMPARTMENT FEATURES

- 1 216-Tool Hex-Head Quarter Turn Lock with 3-Point Latch
- 2 Door Wind Latch
- 3 48 Feed / Pass-Thru Adapters
- 4 432 Subscriber Distribution Adapters
- 5 Cable Attachments
- 6 Fiber Management Spools
- 7 28 Splitter Module Holders

OHC2-432 CABLE COMPARTMENT

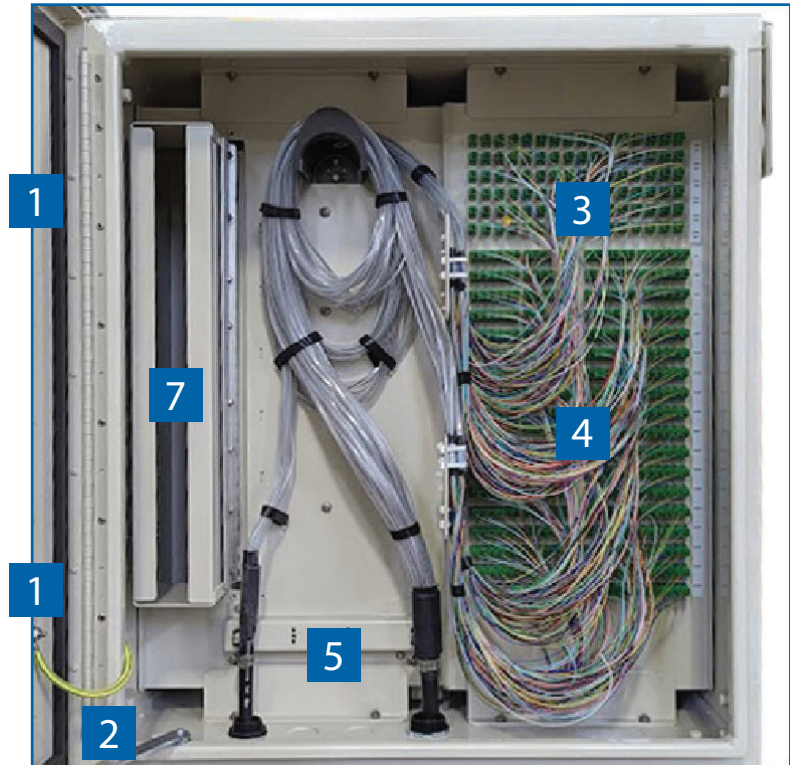

OHC2-432 Optical Hub Cabinet

PART NUMBER CONFIGURATION

OHC2-432 A B C D E F

A. Quantity of Feed Adapters

B = 24
D = 48

B. Quantity of Distribution Adapters

E = 432

C. Mounting Options

A = 6" High Plinth
B = Pole Mount Bracket

D. Intentionally Left Blank

X = (Fill Space with "X")

E. Connector to Stub Cable Type*

A = OSP Dielectric LT, (1) Fiber Feed**, (1) 144 Fiber Distribution and (1) 288 Fiber Distribution
B = OSP Armored LT, (1) Fiber Feed**, (1) 144 Fiber Distribution and (1) 288 Fiber Distribution
C = OSP Dielectric Ribbon, (1) Fiber Feed**, (1) 432 Fiber Distribution
D = OSP Armored Ribbon, (1) Fiber Feed**, (1) 432 Fiber Distribution

F. Connector to Stub Cable Length

C = 100'

* All Stub options will be shipped with connector side installed into bulkhead
** Feed cable count matches feed adapter count

ACCESSORIES

Ordering Number	Description
-----------------	-------------

CFSM-FM2116AA-H	Charles Fiber Splitter Module, Dual 1x16, Pre-Connectorized SC/APC 2mm Yellow Jacketed Output Pigtails, 2mm Blue Jacketed Input Pigtail
CFSM-FM1132AA-H	Charles Fiber Splitter Module, 1x32, Pre-Connectorized SC/APC 2mm Yellow Jacketed Output Pigtails, 2mm Blue Jacketed Input Pigtail
CFSC-2823-00	28 position splitter chassis 23"
97-OHCATTPMKIT	Polemount Brackets

Note: See our CFSM datasheet for more options.

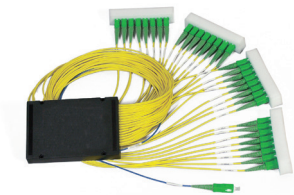

Charles 1x32 Passive Splitter Module

- High quality, low insertion loss
- Bend insensitive jacketed fiber
- Right-sized drop length for better management

Charles Industries, LLC

An Amphenol Company

1450 American Lane, 20th Floor, Schaumburg, IL 60173

 mktsserv@charlesindustries.com

 (847) 806-6300

